

**IMSÜDEN**  **CLUB**

## **VENUE INFO + SPECS**

**Venue name: IMSÜDEN CLUB**

**Venue address: Viktringer Ring 39  
9020 Klagenfurt  
Austria**

**Venue capacity: 400 standing, 150 seated**

**Operating company: ImSü Event GmbH  
Viktringer Ring 37  
9020 Klagenfurt**

# Arrival

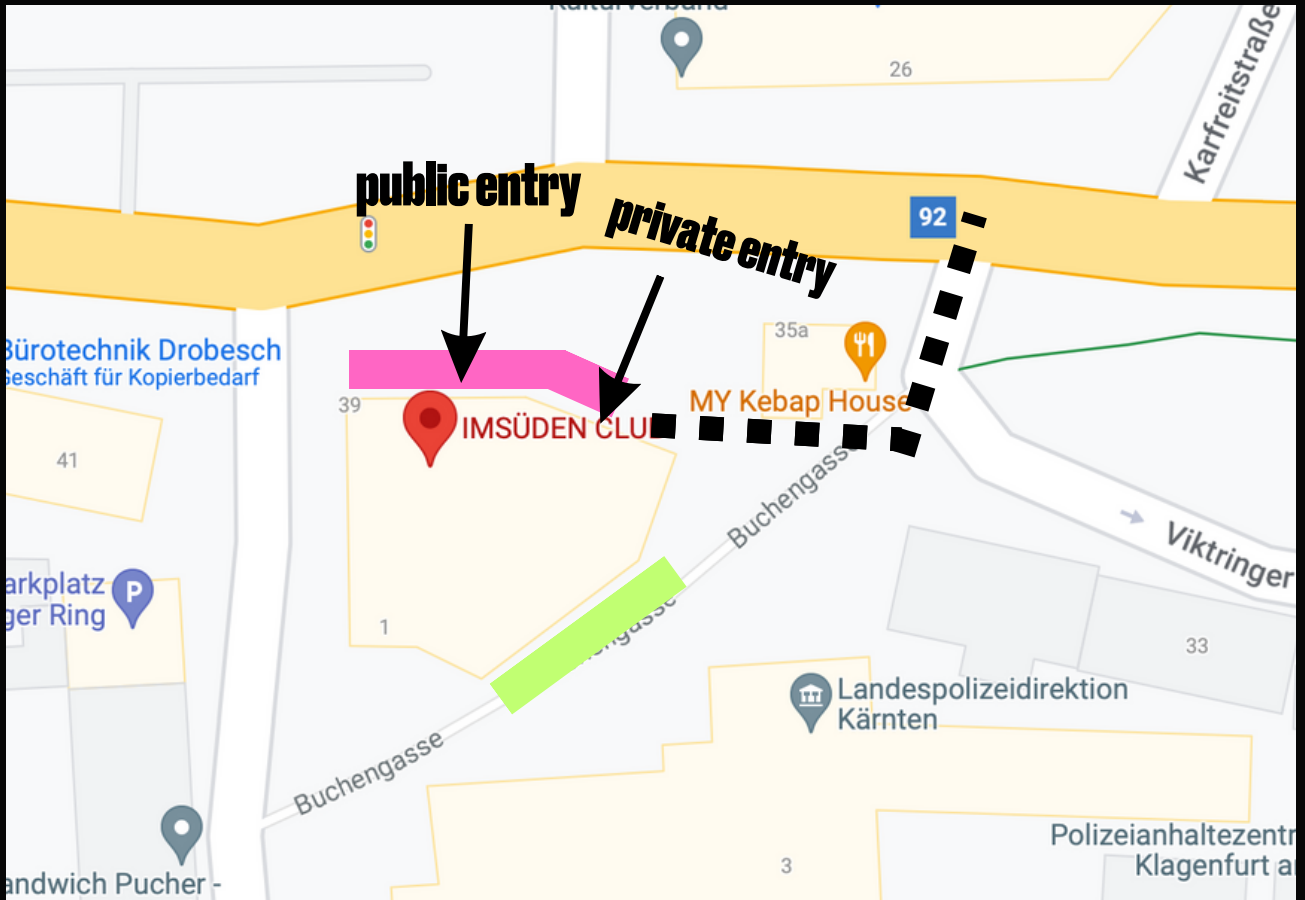

**■ = Parking for load in**

**■ = Nightliner parking**

## For night liners :

**We always need to make reservations regarding bus and truck parking at the venue. These reservations have to be made at least 72h before arrival time. Be sure to advance the parking situation with our production manager.**

**NO RESERVATION = NO PARKING**

## Important info for bands arriving by car:

**Load in/out is possible through the entrance on the Viktringer Ring, afterwards these cars must move to a rental parking in the neighborhood.**

# Specs

Stage: length 7m, depth 4m, height 50cm

## Sound:

### FOH

<b>Behringer x32 Compact</b>	<b>1x</b>
<b>RCF Sub 9004 AS</b>	<b>2x</b>
<b>RCF TTL 4a</b>	<b>2x</b>
<b>RCF TT10 Delay Line</b>	<b>2x</b>
<b>Ten Audio Monitor M1201</b>	<b>6x</b>

### MIC

<b>SHURE SM58LC Vocal Mic</b>	<b>6x</b>
<b>SENNHEISER e906 Mic</b>	<b>2x</b>
<b>SENNHEISER 600 Drumset Mic</b>	<b>1x</b>
<b>K&amp;M 21090 Stand</b>	<b>8x</b>
<b>K&amp;M 25950 Boom Stand</b>	<b>4x</b>
<b>Multicore analog 16/4</b>	<b>2x</b>

## Light:

<b>Wolfmix W1 light mixer</b>	<b>2x</b>
<b>BEAMZ BT270 LED Spots RGBW</b>	<b>4x</b>
<b>SHOWTEC Sunstrip Active MKII</b>	<b>4x</b>
<b>ADJ Saber Spot RGBW</b>	<b>3x</b>
<b>STAIRVILLE LED Pixel Rail 40 RGB MKII</b>	<b>16x</b>
<b>STAIRVILLE LF-12 LED Flash 12 COB Strobe</b>	<b>4x</b>

## Fog:

<b>STAIRVILLE AFH-600 Hazer</b>	<b>1x</b>
<b>ADJ Fog Fury Jett Pro</b>	<b>1x</b>

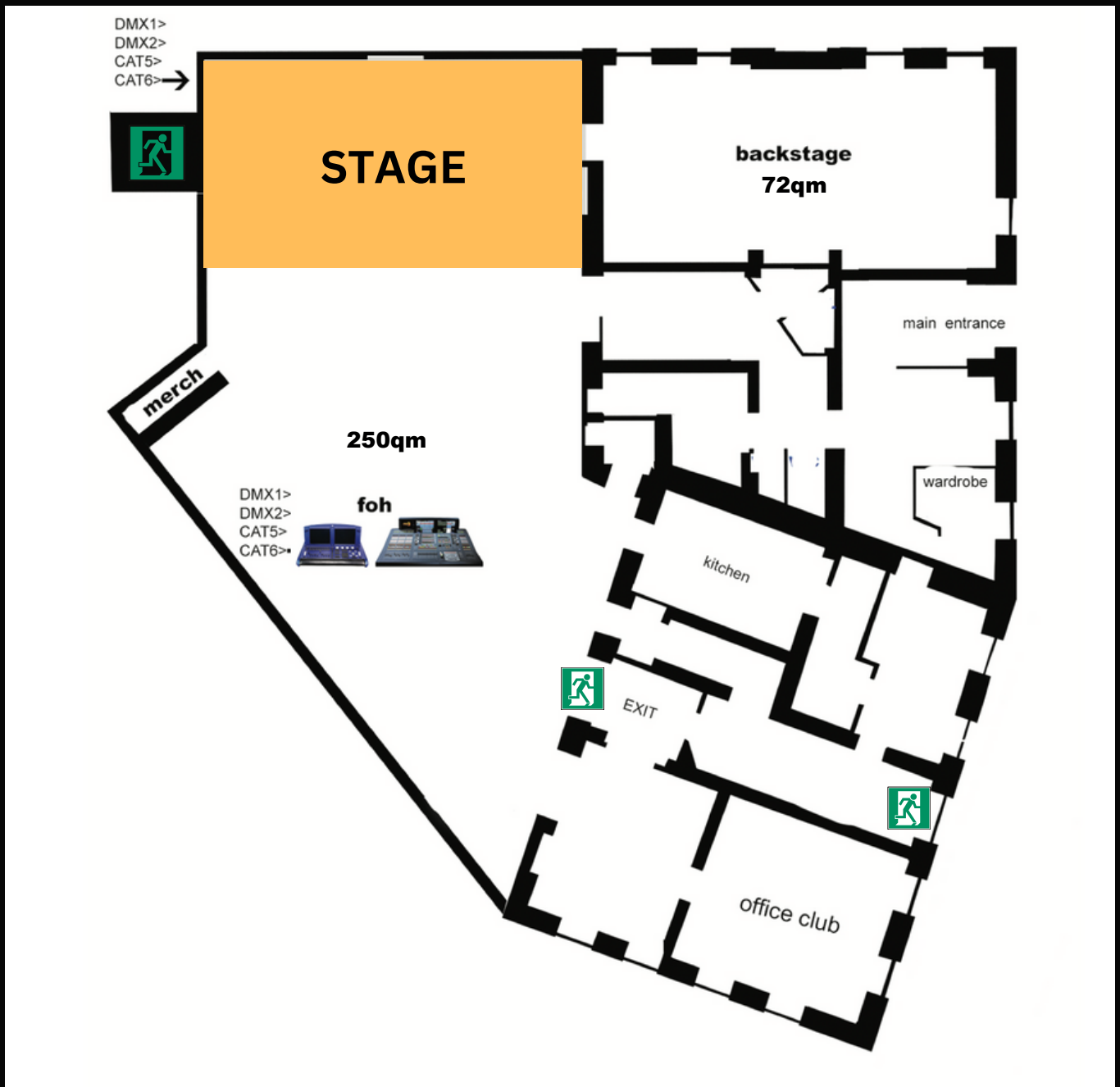

## **SAFETY:**

**IMSÜDEN CLUB is a no-smoking venue that meets all safety requirements issued by the Austrian government. There are sufficient emergency exits and –lighting plus the concert room is completely soundproofed.**

**Use of non-fireproof stage props, smoke machines, effects, etc. have to be checked with the IMSÜDEN technical staff in advance.**

**Updated 14.03.2023**